

# Yanmar type 6LPA-STZP2

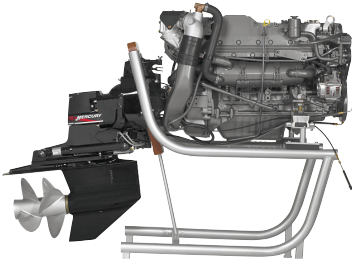

<b>Configuration</b>	4-stroke, vertical, water cooled diesel engine
<b>Maximum output at crankshaft</b>	* 232 kW (315 mhp) / 3800 rpm ** 225 kW (306 mhp) / 3800 rpm
<b>Continuous rating output at crankshaft</b>	211 kW (286.4 mhp) / 3682 rpm
<b>Displacement</b>	4.164 L (254 cu in)
<b>Bore x stroke</b>	94 mm x 100 mm (3.70 in x 3.94 in)
<b>Cylinders</b>	6 in line cylinders, 4- valves per cylinder
<b>Combustion system</b>	Direct injection
<b>Aspiration</b>	Turbocharged with intercooler
<b>Starting system</b>	Electrical starting 12 V - 2.5 kW
<b>Alternator</b>	12 V - 80 A
<b>Cooling system</b>	Fresh water cooling by centrifugal fresh water pump and rubber impeller seawater pump
<b>Lubrication system</b>	Enclosed, forced lubricating system
<b>Direction of rotation (crankshaft)</b>	Counter clockwise viewed from flywheel side
<b>Dry weight without sterndrive</b>	428 kg (944 lbs)
<b>Environmental</b>	EU RCD, US EPA Tier 2, BSO II & EMC
<b>Engine mounting</b>	Rubber type flexible mounting

NOTE: Fuel condition: Density at 15°C = 0.84 g/cm<sup>3</sup>; 1kW = 1.3596 mhp = 1.3410 HP

\* Fuel temperature 25°C at the inlet of the fuel injection pump (ISO 3046-1)

\*\* Fuel temperature 40°C at the inlet of the fuel injection pump (ISO 8665)

**Dimensions** (For detailed line-drawings, please refer to our web-site: [www.yanmarmarine.com](http://www.yanmarmarine.com))

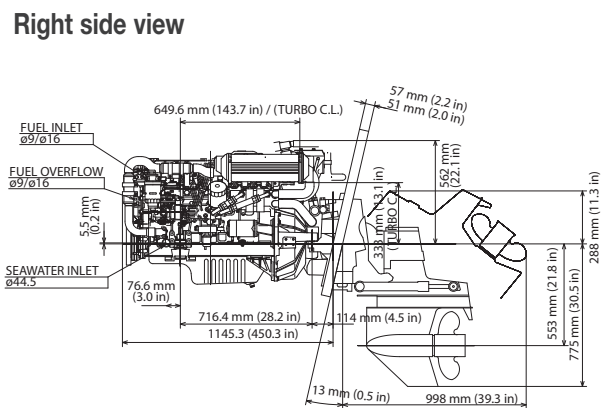
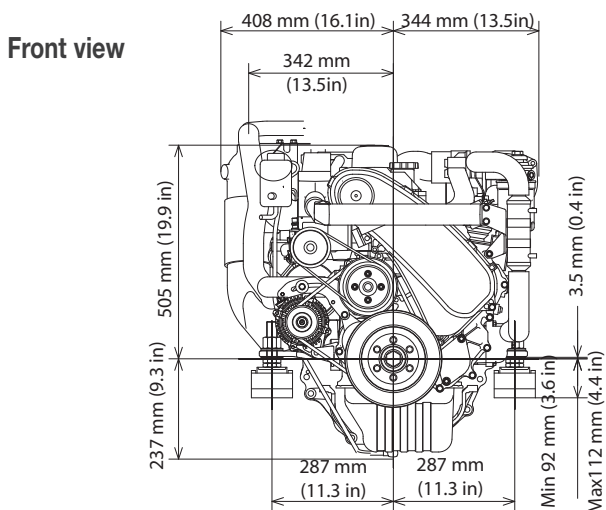

6LPA-STZP2 Bravo2 Sterndrive

## Performance Curves (Output is according ISO 8665)

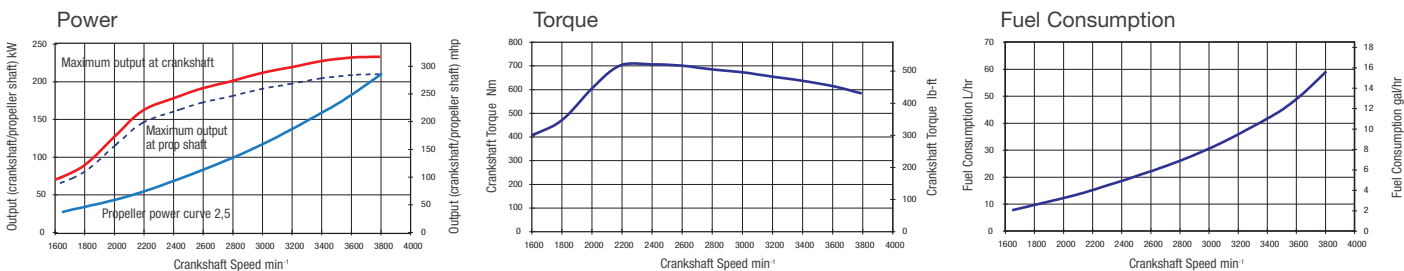

## Yanmar Sterndrive engine set

Model	Yanmar Sterndrive ZT350   Mercruiser Sterndrive (Bravo I, II, III)							
Type	ZT350				Bravo X-2			
Dry weight with propellers	112 kg (247 lbs)				94 kg (207 lbs)			
Reduction ratio (fwd/asn)	1.65/1.65	1.78/1.78	1.97/1.97	2.18/2.18	1.50/1.50	1.65/1.65	1.81/1.81	2.00/2.00
Propeller speed (fwd/asn)	2303/2303	2135/2135	1929/1929	1743/1743	2533/2533	2303/2303	2099/2099	1900/1900
Direction of rotation (propeller shaft - fwd)	Clockwise & counter clockwise viewed from flywheel side				Clockwise & counter clockwise viewed from flywheel side			
Dry weight engine with sterndrive	427 kg (941 lbs)				522 kg (1151 lbs)			
Length engine without sterndrive	1001 mm (39 in)				2230 mm (88 in)			

1. Inner and outer transome surface must be parallel within 3mm in area covered by transome plates and remain within transome thickness limits.
2. Dwg. shows mounting blocks at compressed height of approximately 4mm.
3. Transome angle: 13° to 16°

## Instrument Panels

### New B-type Panel

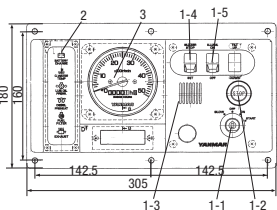

### New C-type Panel

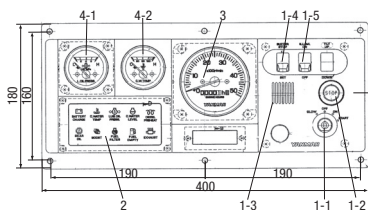

### New D-type Panel

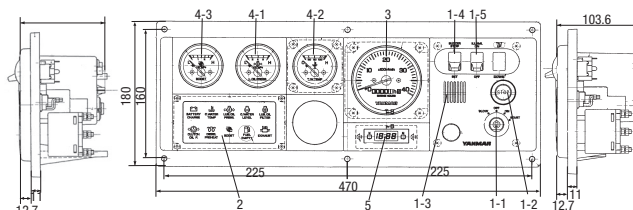

Function	Type of instrument panel		
	New B-type Panel	New C-type Panel	New D-type Panel
① <b>Switch unit</b>			
1-1 Key switch for GLOW/OFF/ON/START (4-position switch)	O	O	O
1-2 Engine stop switch	O	O	O
1-3 Alarm buzzer (C.W. Temp., L.O. Pressure)	O	O	O
1-4 Alarm buzzer stop switch	O	O	O
1-5 Illumination switch for meters	O	O	O
② <b>Alarm lamp unit</b>			
Battery not charging	O	O	O
C.W. high temperature	O	O	O
L.O. low pressure	O	O	O
F.O. drain separator (water level)	O	O	O
Sea water flow	O	O	O
C.W. level for fresh water tank	X	O	O
Boost pressure high	X	O	O
③ <b>Tachometer with hour meter</b>	O	O	O
④ <b>Sub meter unit</b>	X		
4-1 L.O. pressure meter	X	O	O
4-2 C.W. Temperature meter	X	O	O
4-3 Boost meter (turbo)	X	X	O
⑤ <b>Quartz clock</b>	X	X	O

Note: O = Equipped on panel X = Not equipped on panel

## Accessories

### Standard Package

- Sensor for instrument panel (New B, C and D-type)
- Exhaust mixing elbow (L-type)
- Cooling water hoses

### Optional

- Analog instrument panels (New B, C and D-type)
- Flexible mounts (2pcs)
- Exhaust mixing elbow, U-type (high riser)
- Lub oil evacuation pump
- Remark: Engine also available without Hydraulic steering pump for twin installation

- Fuel water separator (integrated with fuel filter)
- Hydraulic Steering pump
- Alternator 12 V - 80 A

- Dipstick for opposite side
- Various Wire Harnesses (4,6,10 m)
- Tie Bar (for twin installation)
- Air venting device for cooling watertank
- VDO instrumentation for main panel and fly bridge

Texts and illustrations are not binding. Yanmar Marine reserves the right to introduce adaptations without prior notification.

6LPA-STZP2 Version: 2008-10